

# 3.74% 2 year Fixed rates for HMOs with £1,995 product fee

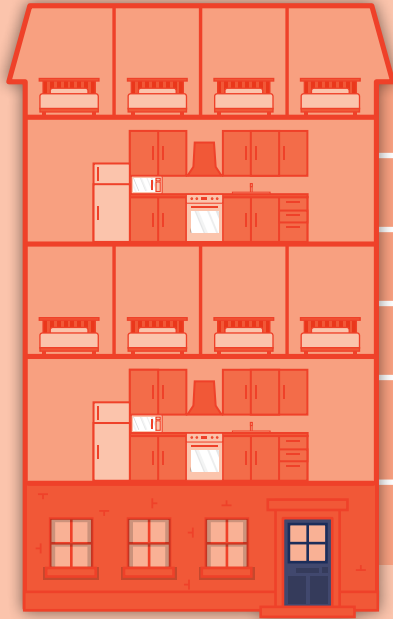

Available for HMOs and Limited Company HMOs

Properties with up to 8 bedrooms and 2 kitchens accepted

Bespoke ICRs based on customer's circumstances from 125%

Maximum loan size £250,000

Portfolio limit of 20 properties with Precise Mortgages (up to a combined value of £5 million)

Available for purchase and remortgage



Our online buy to let calculator is there to help you understand how much your customers could borrow based on their individual circumstances.

## Tier 1 - 75% LTV

LTV	Product type	Rate	Product fee	ERC	Reversion rate	Assessment rate	Product code
75%	2 year Fixed	3.74%	£1,995	4% in year 1 3% in year 2	LIBOR + 3.12%	5.50%	HMOs: UZY67 Limited Company HMO: UZY68

Please refer to the criteria guide and product guide for full information.

Call us | 0161 962 7800  
Visit us | [www.3-mc.com](http://www.3-mc.com)  
Email | [info@3-mc.com](mailto:info@3-mc.com)

